

Site Map (Page 1 of 2)
North Carolina
Monitoring Well Network
Stumpy Point Site, L 6Y
Northeast of Lake Mattamuskeet,
Dare County, NC

NOTE: This map is for informational purposes only. It does not authorize any party to enter onto any lands depicted herein.



Stumpy Point Monitoring Station (3 wells) (detailed insert page 2)

Dare County Bombing Range

Dare County Hyde County

Alligator River National Wildlife Refuge

2000 ft

R10 Monument
Coordinates (04/29/2015)
Latitude: 35.674235
Longitude: -75.905348

West Air
Tower

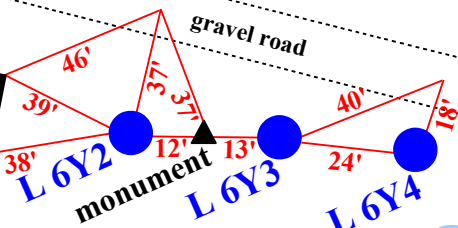

canal

Latitude: 35.674282
Longitude: -75.905311

forest

forest

Stumpy Point
Monitoring
Station
(3 wells)

Dare County
Hyde County

Office of the
Range Manager
Tel. (252)-473-6772

~0.75 miles

~0.35 miles

Stomper Rd
US Hwy 264, ~1.8 miles
gate

500 ft

Site Map (Page 2 of 2)

North Carolina

Monitoring Well Network

Stumpy Point Site, L 6Y

Northeast of Lake Mattamuskeet,
Dare County, NC

NOTE: This map is for informational
purposes only. It does not authorize any
party to enter onto any lands depicted
herein.

